



for all HOPPE
door and window handles!

Secustik[®]



Brass

Vitória Series



Aluminium

Marseille Series



Stainless Steel

Helsingborg Series

Program for windows and
balcony doors

Tôkyô Series

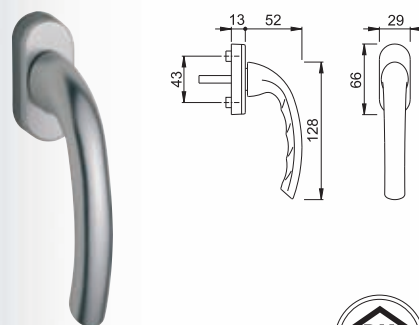

Tôkyô Series
0710/U26

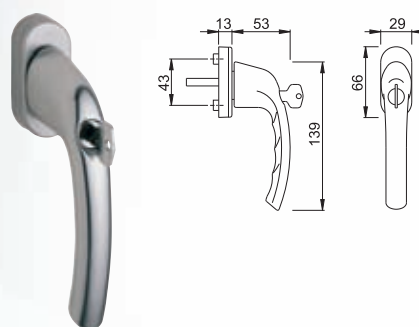

Tôkyô Series
0710S/U26

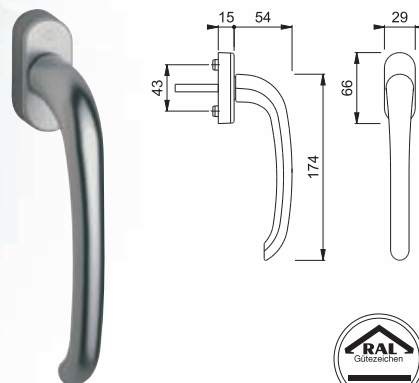

Tôkyô Series
0735/U26

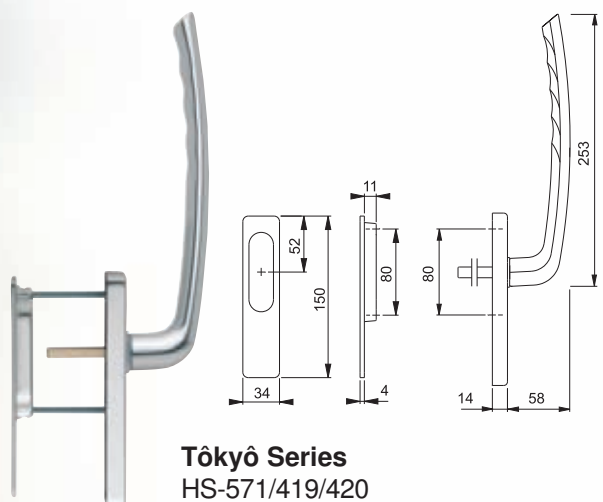

Tôkyô Series
HS-571/419/420

Tôkyô Series



Tôkyô Series
76G/3346/1710RH

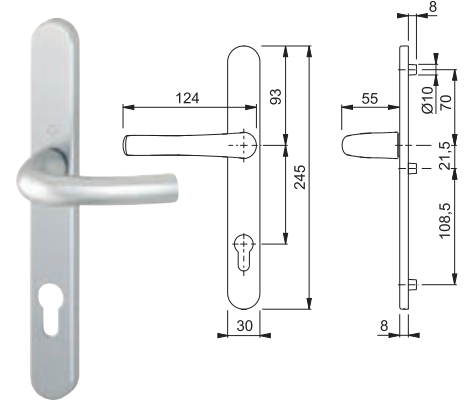
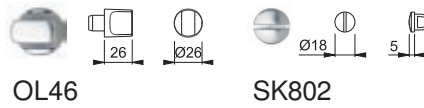
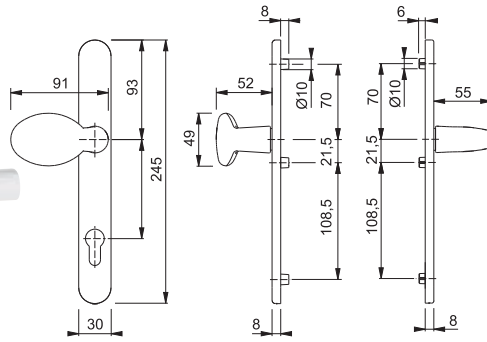

Tôkyô Series
1710RH/3346

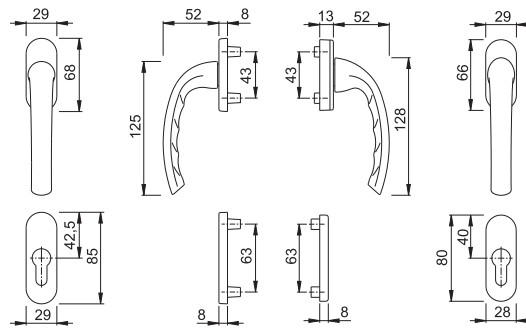
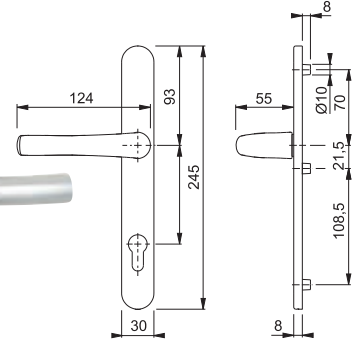

Tôkyô Series
0710RH/66N/U26/0710/66NS/49PNS

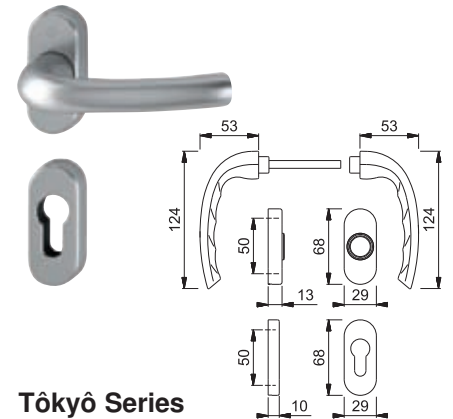

Tôkyô Series
1710RH/30P/30PS

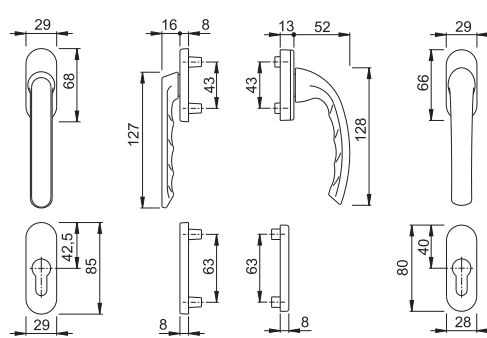
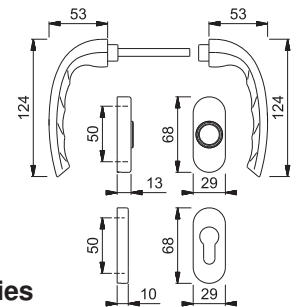

Tôkyô Series
099KH/66N/U26/0710/66NS/49PNS

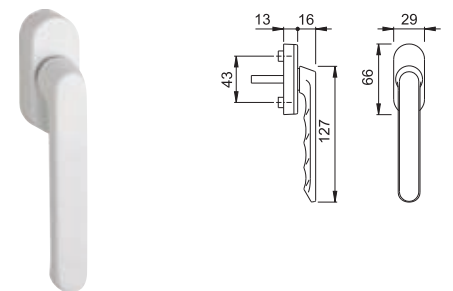

Luxembourg Series
099KH/U26

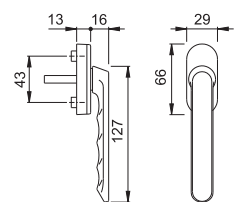

Aluminium:

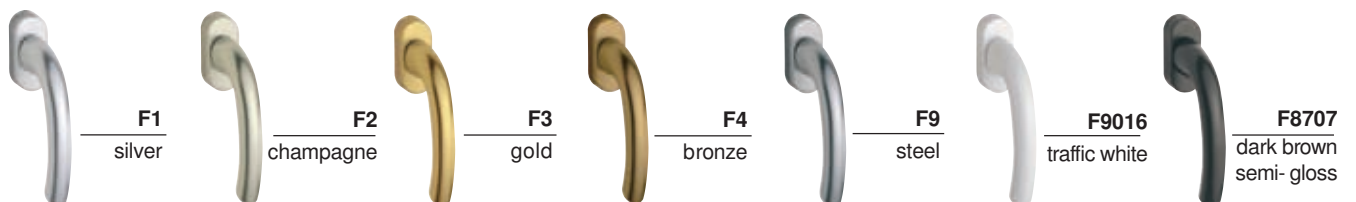

Atlanta Series

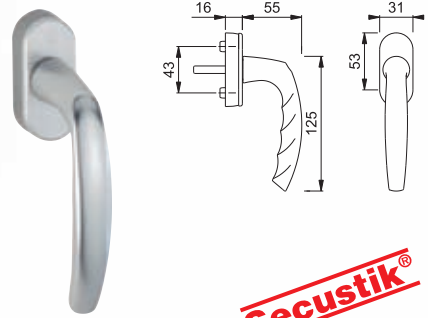

Secustik®



Atlanta Series
0530/US952

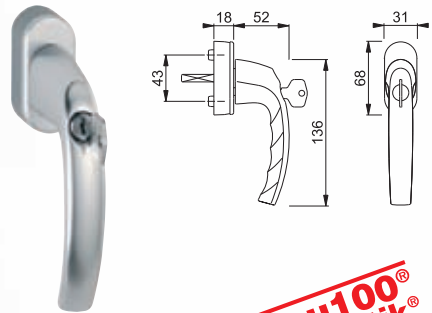

**Secu100®
+ Secustik®**

Atlanta Series
0530S/US952

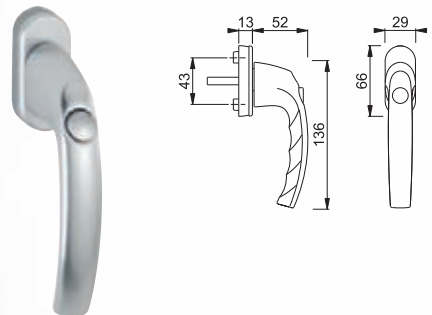

Atlanta Series
0530SV/U26

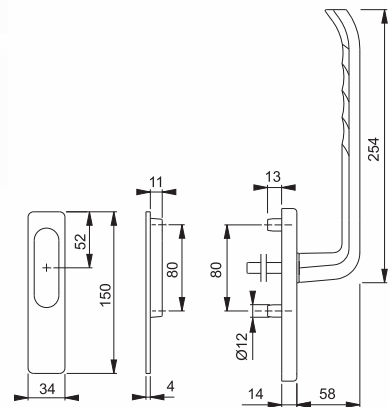

Atlanta Series
HS-575/419/420

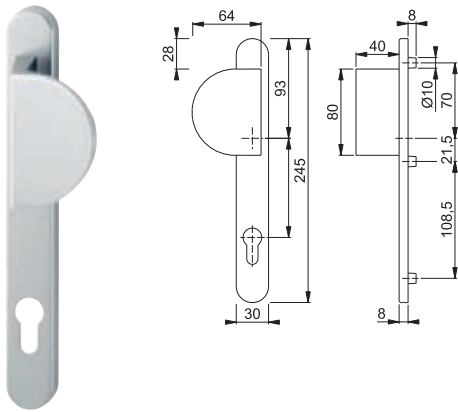

Atlanta Series
554/3346 - right 554/3346 - left

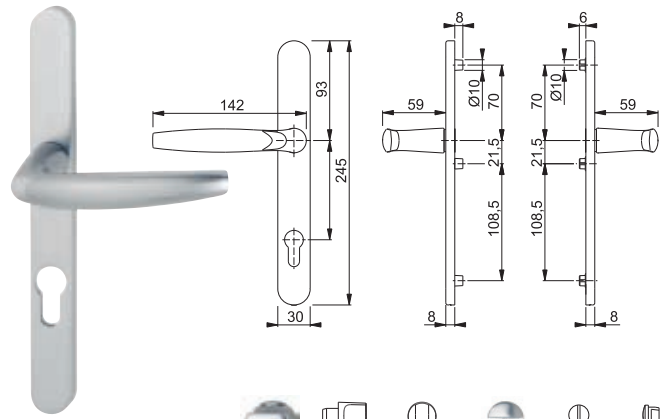

Atlanta Series
1530/3346

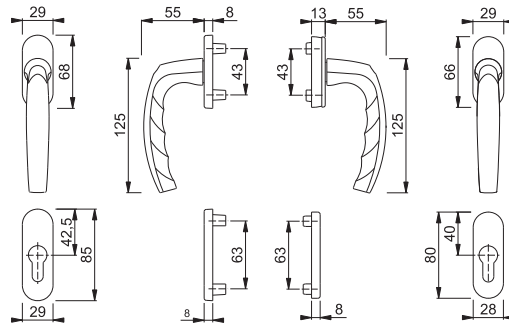

Atlanta Series
0530/66N/U26/0530/66NS/49PNS

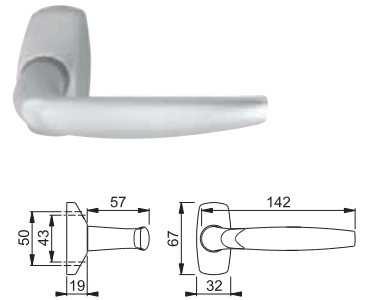

Atlanta Series
1530G/831 F1-4, F9016

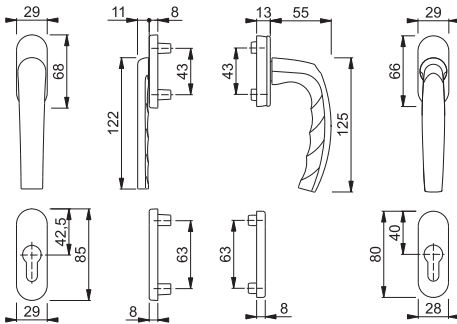

Atlanta Series
099KH/66N/U26/0530/66NS/49PNS



Atlanta Series
832S-SK PZ F1-4, F9016

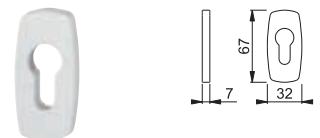

Atlanta Series
833S-SK PZ F1-4, F9016

Aluminium:

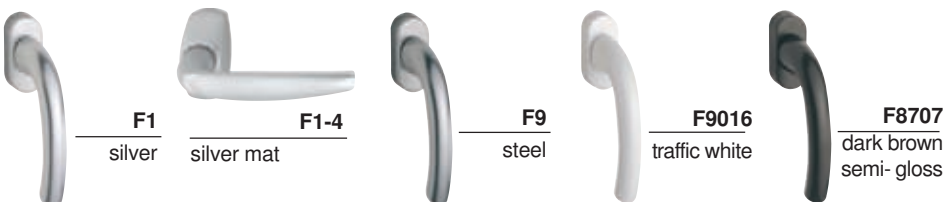

Brest Series

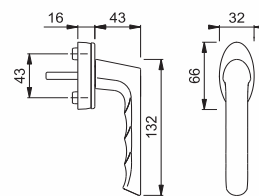

Secustik®



Brest Series
0739/US954
and
0739S/US954 Secu100® + Secustik®

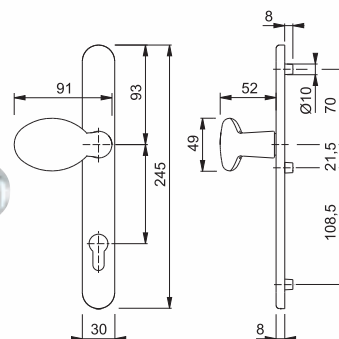

76G/3346

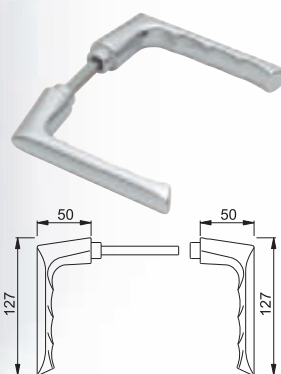

Brest Series
Lever: 1739RH

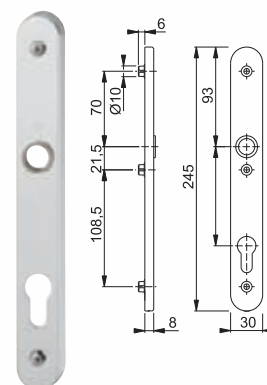

Backplate: 3346



Aluminium:



F1
silver



F9
steel



F9016
traffic white



F8707
dark brown
semi-gloss

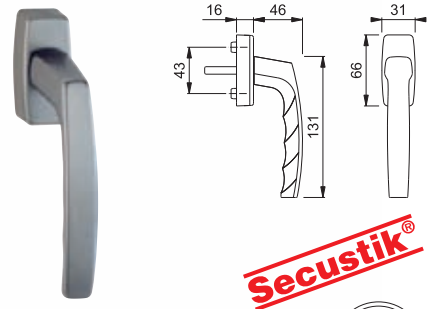

Secustik®



Metz Series
0738/US945
and
0738S/US945 Secu100® + Secustik®

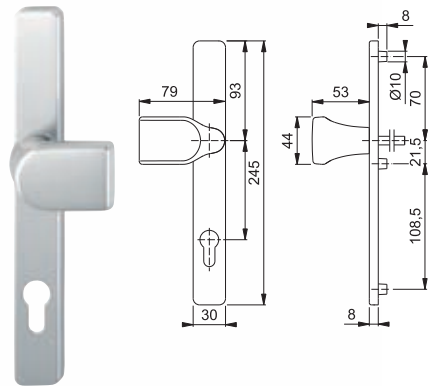

78G/2246

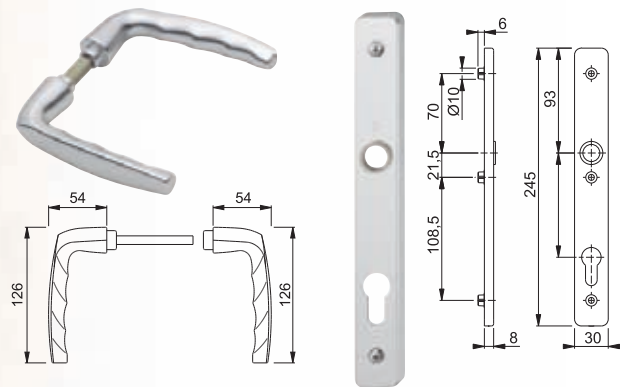

Metz Series
Lever: 1715

Backplate: 2246



Aluminium:

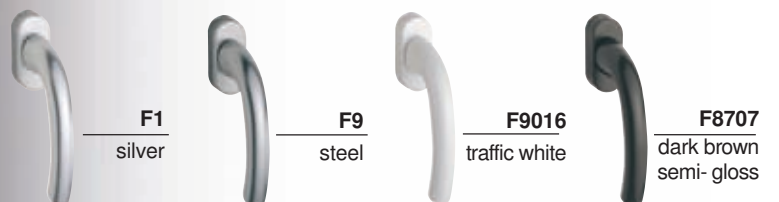

Brass Window Handles

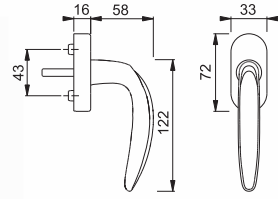

Secustik®



Atlanta Series
M0530/US956



Roissy Series
M0941/U23

Seattle Series
M068L/U23



Athinai Series
M056/U937

Genova Series
M0535/US956

Vitória Series
M0515/US956

Brass:



F71
polished



F41
satin
chrome



F49
polished
chrome



F77-R
brass coloured
polished -
Resista®

Resista®
10 years' surface
guarantee

Stainless Steel Window Handles

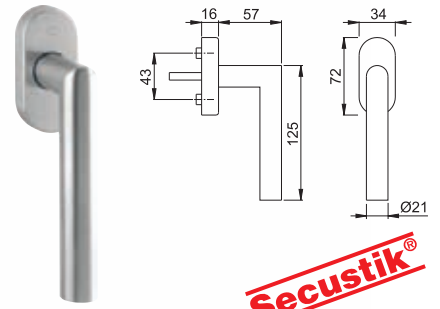

Amsterdam Series
E0400/US956



Bilbao Series
E0365/US956

Cardiff Series
E0850/US956



Helsingborg Series
E0730/US956

Las Vegas Series
E0440/US956

Trondheim Series
E0430/US956

Stainless steel:



F69
brushed



Secustik®, the window handle with the built-in security you can hear

Secustik® window handles contain a patented jamming-device which provides integrated security. This helps to prevent unlawful moving of the window-fitting from outside. It works by a coupling element acting as a sort of mechanical diode. This allows for normal use of the window handle from inside, but jams the handle if anyone tries to turn it from outside by way of the fitting.

In this way, the handles meet the requirements of AhS RAL-RG607/13. As the handle is turned through 180 degrees from the closed position to the tilt position, the jamming-device makes a series of clicks - proof of the **built-in security you can hear**.



Secustik® is a registered trademark and protected by patent.

Secu100® + Secustik® = the new standard for ease and built-in security you can hear

The Secu100® + Secustik® window handle combines the technology of the Secu100® and Secustik® thereby creating a high standard of mechanical safety when locked, but also a permanent basic security when not locked.

Secu100® + Secustik® – The most important advantages

- the handles meet the requirements of the European pre-standard DIN V EN 1627-1630 and are thereby able to be sold throughout the European Union
- they also meet the requirements of all resistance classes of DIN V EN 1627-1630, when used with the appropriate window.

Secu100® + Secustik® is a registered trademark.





the Secu100® technology is able to resist a forceful **turning** or **pulling** of the window-handle from the rosette up to 100Nm.

10-year operational guarantee for all HOPPE door and window handles

The new quality standard for brand-name hardware



| Test criteria according to DIN EN 1906 |  |
|---|---|
| Residential: 100,000 test cycles | |
| Non-residential: 200,000 test cycles | |

| Test criteria according to RAL-RG 607/9 |  |
|---|---|
| 10,000 operational test cycles | |

| HOPPE test criteria |  |
|--|---|
| Residential: 182,500 operational test cycles on the door | |
| Non-residential: 255,500 operational test cycles on the door | |

| HOPPE test criteria |  |
|---|---|
| 15,000 operational test cycles on the window | |

- Countless spot checks in the form of durability tests and static impact tests have been carried out, reflecting the everyday knocks door and window handles have to take.

Far more test cycles were conducted by HOPPE than required by DIN EN 1906 and RAL RG 607/9 and these tests were made with the handles actually on the door or window frame.

- With the 10-year operational guarantee, HOPPE extends way beyond the statutory 2 years of European regulations.



The Product Range

Everyone wishing to enhance his surroundings is sure to find something to suit his taste from HOPPE's extensive range of attractively designed door and window handles, providing customers with an appropriate handle of excellence in a choice of aluminium, brass, nylon or stainless steel.



Whether for internal doors and windows, or for the main entrance itself, HOPPE products are sure to add the perfect finishing touch.

With HOPPE products offering high quality at a competitive price, it is easy to see not only why they are the professionals' first choice but also why the company has become Europe's leading door and window handle manufacturer.



The HOPPE Group

Founded by Friedrich Hoppe in 1952 in Heiligenhaus (near Düsseldorf), the traditional heartland of Germany's lock and hardware industry, HOPPE is today an international manufacturing company with its headquarters in Switzerland.



Approx. 3,000 employees in 9 production plants in Europe and the USA plus sales offices in Switzerland, France, Spain, the UK and the USA as well as representative offices in Russia, Finland, Sweden and China, dealing with sales worldwide, ensure that the "Handle of excellence" provides the finishing touch to your interior decor.



HOPPE is considered to be the Euro-pean market leader in development, production and distribution of door and window hardware.

The Environment

HOPPE regards the protection of the environment with utmost importance. Examples of measures taken include:

- the manufacture of hardware in an environmentally-considerate way
- the recycling of waste-water and the use of a circulatory system for water required in manufacture
- bio-degradable packaging
- the use of recyclable scrap as secondary raw material in the internal raw material cycle
- the use of process heat



The Handle of Excellence

Enjoy the feel of quality. Indeed, touching a quality handle reassures you that you have made the right choice. Hardware with this logo  is a brand-name product, which, in our view, is tantamount to a promise of quality.



Appointed Distributor:

HOPPE AG · Via Friedrich Hoppe · CH-7537 Müstair
 +41 (0)81 851 66 00 ·  <http://www.hoppe.com>
 +41 (0)81 851 66 66 ·  info.ch@hoppe.com